

Art.-Nr.	Länge / Length (mm)
65266	3000+30
65267	5000+30

**PIN-Zuordnung/PIN Assignment**

P1	P2
1	12
3	10
2	11
4	9
6	7
5	8
7	6
9	4
8	5
10	3
12	1
11	2
15	15
17	17
16	16
13	13
14	14
18	18
19	19
SHELL	SHELL

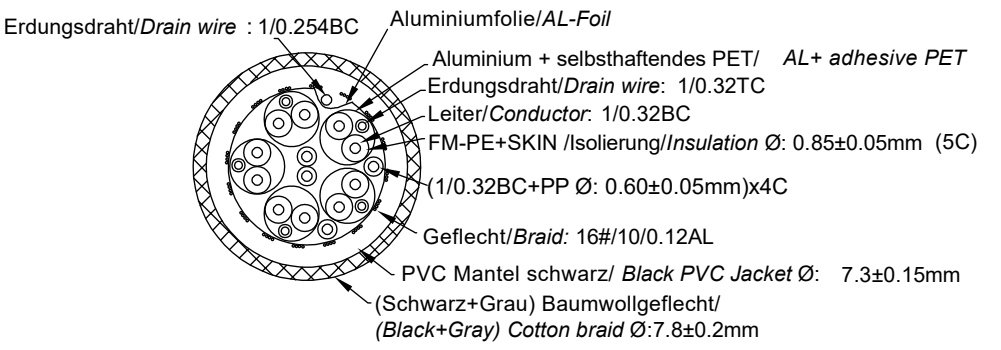
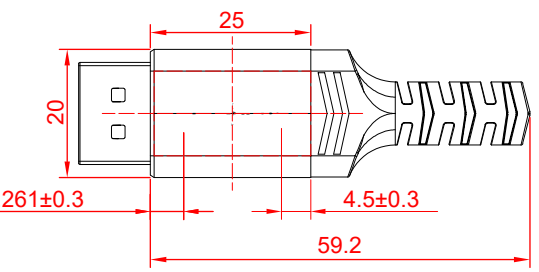
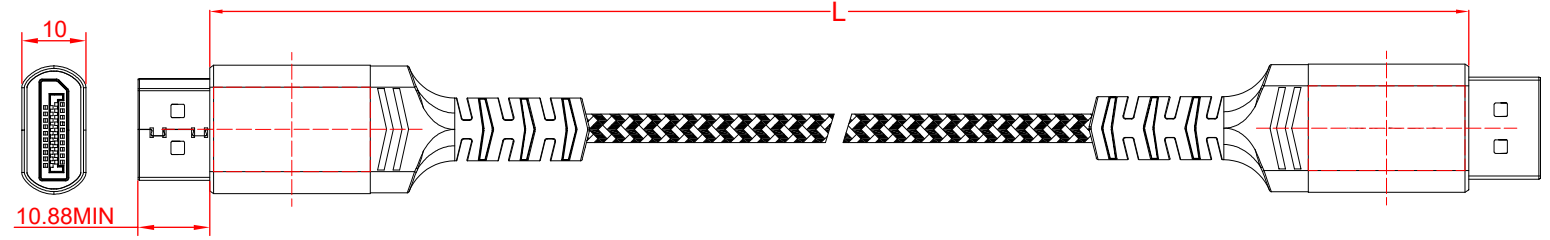
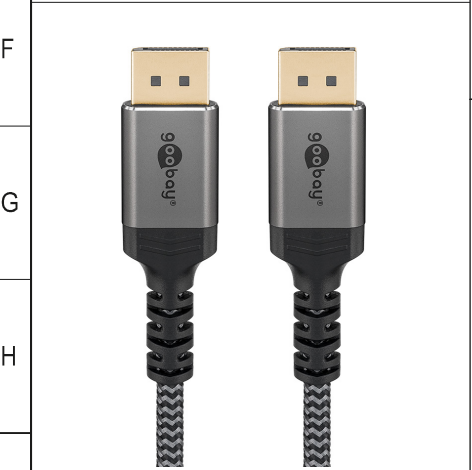

**DisplayPort™-Kabel (8K@60Hz)**

- DisplayPort™-Kabel 1.4 zur hochauflösenden Videoübertragung
- vergoldete Stecker beugen Korrosion vor und sind besonders langlebig

Anschluss 1:	DisplayPort™-Stecker
Anschluss 2:	DisplayPort™-Stecker
Knickschutz:	ja
Kabeltyp:	Rundkabel
Max. Übertragungsrate:	32,4 Gbit/s

**DisplayPort™ Cable (8K@60Hz)**

- DisplayPort™ cable for high-resolution video transmission
- gold-plated plugs prevent corrosion and are especially durable

Connection 1:	DisplayPort™ plug
Connection 2:	DisplayPort™ plug
Kink protection:	yes
Cable type:	round cable
Max. data transmission rate:	32.4 Gbit/s

Änderungen		Datum	Name	Bezeichnung	Blatt
Datum	Name	gez.:	alw	DP 1.4 Kabel G+ XXXX X, XM	
		gepr.:	tp		
		Norm:		Zeichnungs-Nr.:	
Änderungen vorbehalten / Subject to change				65266, 65267	von